

Mar 31, 2021 - 9:28am
 Drawing Location: M:\Projects\1919-1920 - Malahide Road\Drawings\Waterman Moylan\Civil\Planning\Amended Drawings\1920-1921\1921 0114_Signlines Layout.dwg

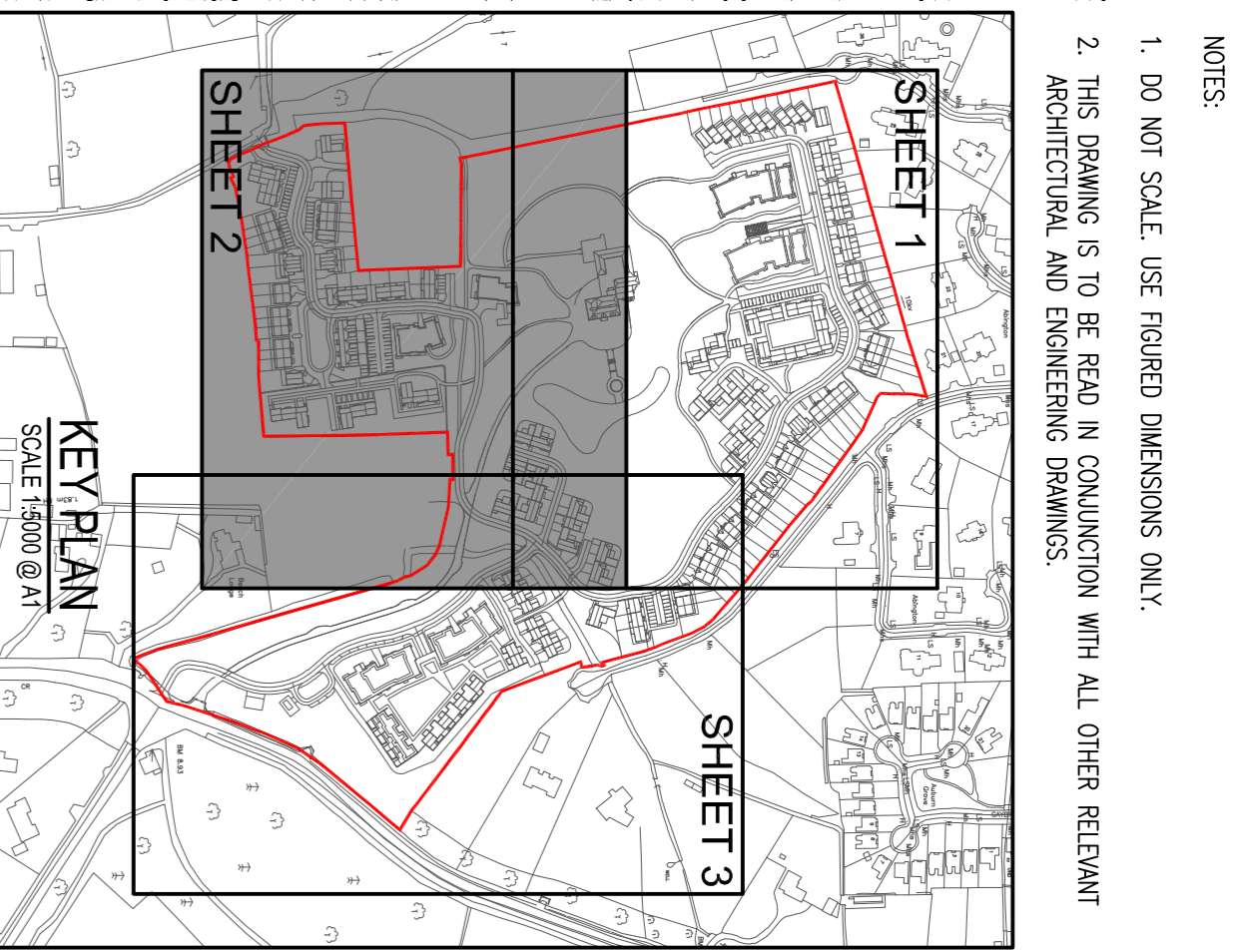

- NOTES:
1. DO NOT SCALE. USE FIGURED DIMENSIONS ONLY.
 2. THIS DRAWING IS TO BE READ IN CONJUNCTION WITH ALL OTHER RELEVANT ARCHITECTURAL AND ENGINEERING DRAWINGS.

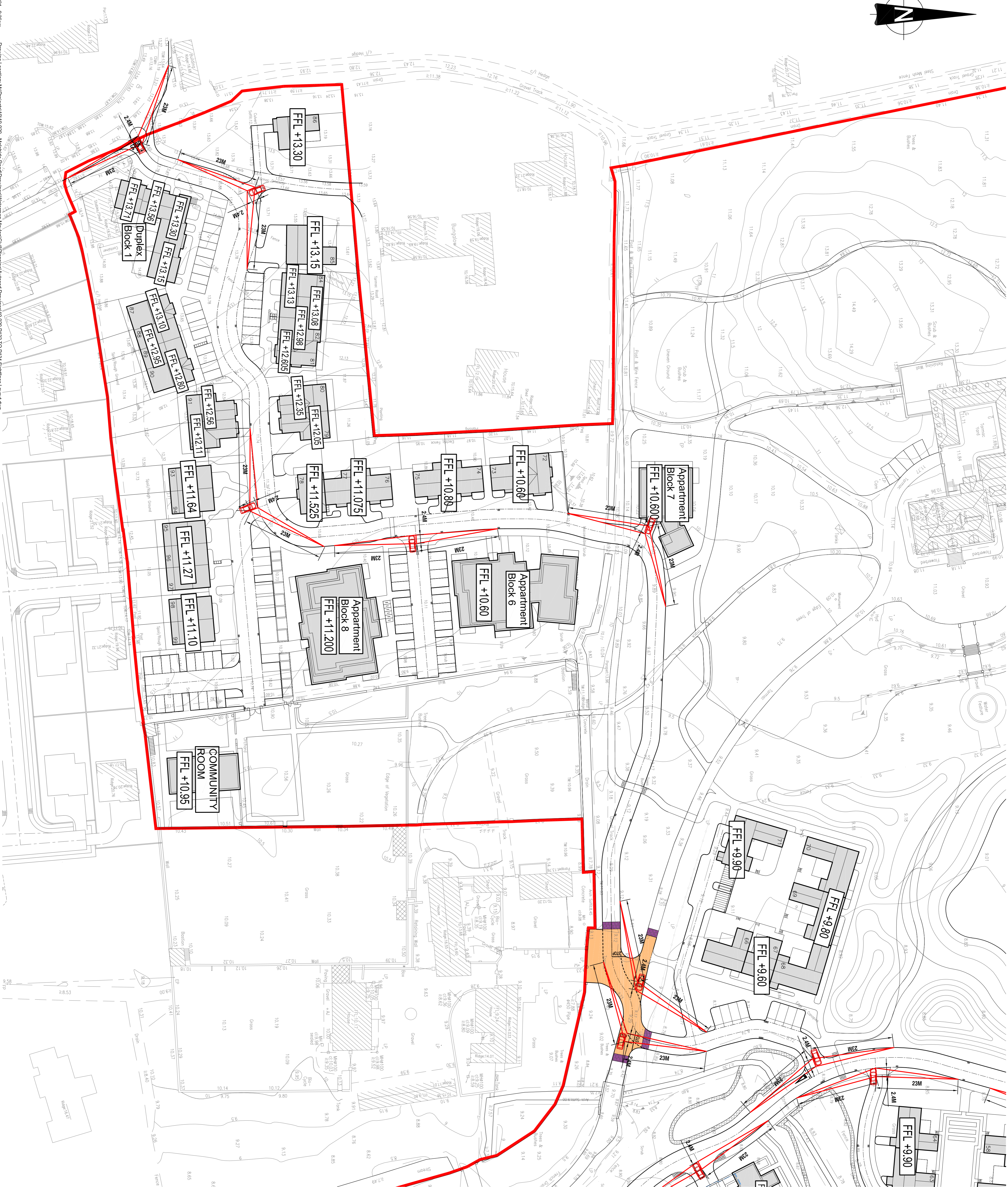
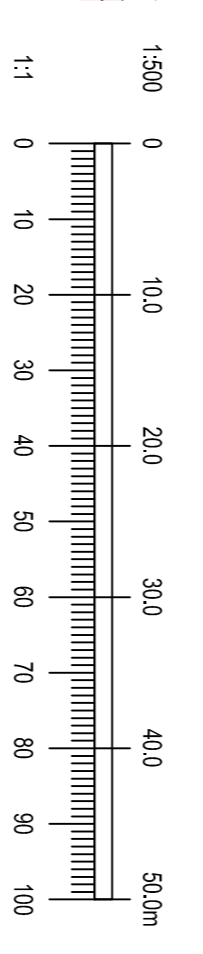

Ordnance Survey Ireland Licence No. EN 0006021
 ©Ordnance Survey Ireland/Government of Ireland.

REV. DATE	AMENDMENT	DRN	APPD

STATUS
PLANNING

Waterman Moylan
 Engineering Consultants
 BLOCK 5, EASTPOINT BUSINESS PARK, ALFIE BRYNE ROAD,
 DUBLIN D03 K7W7 IRELAND.
 Tel: (01) 604 8800 Fax: (01) 684 3818
 Email: info@watermanmoylan.ie www.watermanmoylan.ie

CLIENT
 KINNEST LTD.

ARCHITECT
 CONROY CROWE KELLY ARCHITECTS

PROJECT
 ALBURN, MALAHIDE, CO. DUBLIN

TITLE			
SIGNLINES LAYOUT			
SHEET 2 OF 3			
DRAWN	DESIGNED	APPROVED	DATE
PJD	MD	MD	MAR 21
SCALE	JOB NO.	PRJ NO.	REVISION
1:500 @ A1	19-020	P133	

© 2021 Waterman Moylan Engineering Consultants. All rights reserved. This drawing is the property of Waterman Moylan Engineering Consultants and is not to be reproduced without the written consent of Waterman Moylan Engineering Consultants.